

AMENDED PALOMINO FIELDS PLAT-DIVISION I

Receiving No.

LP - 07-31

271818

A REPLAT OF PALOMINO FIELDS PLAT-DIVISION I A PORTION OF THE NE 1/4 OF THE NW 1/4 OF SECTION 27, TOWNSHIP 18 NORTH, RANGE 18 EAST, W.M. KITITAS COUNTY, WASHINGTON

DEDICATION

KNOW ALL MEN BY THESE PRESENTS that do hereby declare this plat and dedicate to the public forever all roads and ways hereon with the right to make all necessary slopes for cuts and fills, and the right to continue to drain said roads and ways over and across any lot or lots, where water might take a natural course, in the original reasonable grading of the roads and ways shown hereon. Following original reasonable grading of roads and ways hereon no drainage water on any lot or lots shall be diverted or blocked from their natural course so as to discharge upon any public road rights-of-way, or to hamper proper road drainage. Any enclosing of drainage waters in culverts or drains or rerouting thereof across any lot as may be undertaken by or for the owner of any lot, shall be done by and at the expense of such owner.

The owners of the land described herein in fee simple are Frederick J. Niemi and Carrie L. Niemi, husband and wife, as to Lot 1, Randall W. Larsen, a single man and Tiffany M.W. Love, a single woman, who are described as joint tenancy with rights of survivorship on the documents in which title vests, as to Lot 2, SSSI, LLC, a Delaware limited liability company, as to Lot 3, Monty Balcom and Betty Balcom, husband and wife, as to Lot 4, Ethan Sterkel and Mackenzie Sterkel, husband and wife, as to Lot 5, Joseph McNeil and Erin McNeil, husband and wife, as to Lot 6, William S. Finch and Sherry J. Finch, husband and wife, as to Lot 7, and Wendy Kernan, an unmarried woman, as to Lot 8.

IN WITNESS WHEREOF, we have hereunto set our hands and seal.

Frederick J. Niemi	Date
Carrie L. Niemi	Date
Randall W. Larsen	Date
Tiffany M.W. Love	Date
Manager, SSSI LLC	Date
Monty Balcom	Date
Betty Balcom	Date
Ethan Sterkel	Date
Mackenzie Sterkel	Date
Joseph McNeil	Date
Erin McNeil	Date
William S Finch	Date
Sherry J. Finch	Date
Wendy Kernan	Date

ORIGINAL PROPERTY DESCRIPTION

TRACT 1:
That portion of the Northwest Quarter of the Northwest Quarter lying East of the center line of the channel of Reecer Creek, as located in October 3, 1967, in Section 27, Township 18 North, Range 18 East, W.M., in the County of Kittitas, State of Washington:

AND

The Northeast Quarter of the Northwest Quarter of Section 27, in Township 18 North, Range 18 East, W.M., in the County of Kittitas, State of Washington; EXCEPTING THEREFROM:

A tract of land bounded by a line described as follows: Commencing at the Northeast corner of the Northwest Quarter of said Section 27; and running thence South 15' West, 1,321.5 feet; thence North 89°35' West, 500 feet; thence North 27°47' West, 838 feet; thence North 0°2' West, 879 feet; thence North 59°50' East, 79.8 feet; thence East 853.76 feet; thence South 334.09 feet to the point of commencement.

The right of way of the canal of the Ellensburg Water Company (Town Ditch).

TRACT 4:
That portion of the Northeast Quarter of the Northwest Quarter of Section 27, Township 18 North, Range 18 East W.M., County of Kittitas, State of Washington, described as follows:

A tract of land bounded by a line beginning at the Northeast corner of said quarter of quarter section and running thence South 0°15' West along the East boundary line of said quarter of quarter section 377.5 feet; thence West 904.7 feet; thence North 2°02' West 377.5 feet to the North boundary line of said section; and thence South 89.39' East along said North boundary line 917.0 feet to the point of beginning.

EXCEPTING THEREFROM the right-of-way for the County Road known as Reecer Creek Road.

AND EXCEPTING THEREFROM the right-of-way of the Ellensburg Water Company Canal.

TRACT 5:
That portion of the Northeast Quarter of the Northwest Quarter of Section 27, Township 18 North, Range 18 East, W.M., County of Kittitas, State of Washington, described as follows:

A tract of land bounded by a line beginning at the Northeast corner of the Northeast Quarter of the Northwest Quarter of said section; thence South 00°15'00" West along the East boundary line of said quarter of quarter section a distance of 377.5 feet to the true point of beginning; thence South 00°15'00" West along the East boundary line of said quarter of quarter section a distance of 34.40 feet; thence North 89°24'55" West a distance of 903.64 feet; thence North 02°11'00" West a distance of 25.19 feet; thence South 90°00'00" East a distance of 904.70 feet to the true point of beginning.

EXCEPTING THEREFROM the right-of-way for the County Road known as Reecer Creek Road,

AND EXCEPTING THEREFROM the right-of-way of the Ellensburg Water Company Canal.

ACKNOWLEDGEMENTS

For Acknowledgements Refer to Sheet 6 of 6

PROPERTY DESCRIPTION AS RESULT OF SURVEY

That portion of the Northeast quarter of the Northwest quarter of Section 27, Township 18 North, Range 18 East, W.M., County of Kittitas, State of Washington, as delineated and described on the PALOMINO FIELDS PLAT - DIVISION I drawing prepared by Western Pacific Engineering and Survey, Inc., dated August, 2017, and as described as follows:

Commencing at the a 3 - inch brass cap monument found in a monument case marking the northeast corner of the Northwest quarter of said Section 27; thence North 89°30'21" West, coincident with the north boundary line of the Northwest quarter of said Section 27, a distance of 30.00 feet to the west right-of-way boundary line of the county road known as Reecer Creek Road and to the POINT OF BEGINNING; thence South 00°15'36" East, coincident with the west right-of-way boundary line of said County Road, a distance of 383.70 feet, said course being parallel with and 30.00' west of the west boundary line of the Northwest quarter of said Section; thence North 89°55'28" West a distance of 873.31 feet; thence North 02°15'32" West a distance of 310.40 feet; thence North 89°30'21" West a distance of 82.35 feet; thence South 00°29'39" West a distance of 56.99 feet; thence North 89°30'21" West a distance of 143.70 feet; thence North 09°18'41" West a distance of 139.02 feet to the north boundary line of the Northwest quarter of said Section 17; thence South 89°30'21" East, coincident with the north boundary line of the Northwest quarter of said Section 27, a distance of 1132.88 feet to the POINT OF BEGINNING;

Containing 8.454 ACRES, more or less.

Said parcel also being described as follows:

Lots 1 through 8, Palomino Fields Plat - Division I, in the County of Kittitas, State of Washington, as per plat thereof recorded in Book 12 of Plats, pages 201 through 205 and amended under Book 12 of Plats, pages 237 through 241, records of said County.

NOTICE

This is a Boundary Line Survey and as such is not intended to show, nor does it purport to show, all easements and encumbrances.

This survey was prepared for the exclusive use of the person, persons, or entity named in the Surveyor's Certificate hereon. Said certificate does not extend to any unnamed person without an expressed recertification by the Surveyor naming said person.

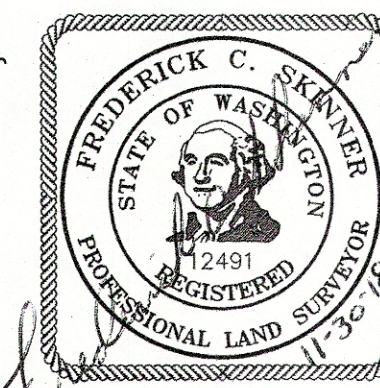

INSTRUMENT USED Trimble R10 GPS Receivers	INDEXING DATA S27 T18N R18E
Traverse Closure Meets Standards Per WAC 332-130-090	
WESTERN PACIFIC ENGINEERING AND SURVEY, INC.	
Pioneer Way Professional Center 1328 Hunter Place (509)765-1023 Moses Lake, Wash.	
LCU	
A Portion of the NE 1/4 of the NW 1/4 of Section 27, Township 18 North, Range 18 East, W.M. AMENDED PALOMINO FIELDS PLAT - DIVISION I Grant County Washington	
Surveyed by LMH Date 04-16	Scale 1" = N/A
Drawn by Tml/FCS Date 10-18	Sheet 5 of 6
Checked by FCS Date 10-18	Project No. 15169